

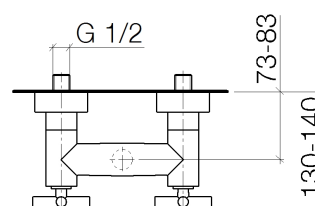

Product specifications

- 3/8" female or 1/2" male connection
- Flanges \varnothing 2-1/2"
- 1/2" connection
- Center to center 5-7/8" \pm 5/8"

NOTE: Local building codes may require the use of an anti-scald device. Please refer to remote pressure balance valve (35 910 970 90) Internal backflow preventer.

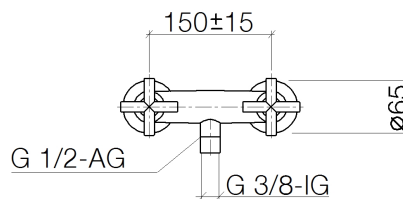

Surfaces

- | | |
|-----------------|-------------|
| • chrome | 26100892-00 |
| • matt platinum | 26100892-06 |
| • platinum | 26100892-08 |
| • matt black | 26100892-33 |

Accessories required

- Rough-in adapter; 35 080 970

Order quantity

No.	Article number	Name	Installation quantity
1	0411040300090	connection	2
2	092789103ff	rosette	2
3	09141003490	seal	2
4	0429050140090	nipple	2
5	092310064ff	nut	2
6	09141003290	seal	1
7	092403121ff	nipple	1
8	09230113190	back-flow preventer	1
9	092102143ff	sleeve	1
10	9090031310090	top	2
11	04208901000ff	handle	2
12	09303007590	screw	2
13	09301102990	disc	2
14	90121200700ff	base	2
15	092089010ff	handle	2

