

A³form

Technical data sheet



Washstands

WT.QS325X

Article number: 4272000000

Design partner: busalt design

Features

Description	WT.QS325X
Article number	4272000000
Standard colour	White
Special surfaces	White easy-clean (XXXX XXX 400) White antibacterial (XXXX XXX 401)
Construction	without faucet hole, without overflow
Special versions	special- or matt colour
Dimensions	12 3/4 x 12 3/4 x 11 3/4"
Material	Glazed steel
Net weight	16.76 lbs
Installation	for wall connection
Accessoires	Bottle trap SI.2, Bottle trap SI.3
Faucet information	Optimum point of impact approx. 4 3/8 – 5 1/8" from rear edge of basin.

Faucets with a vertical outlet and an aerator provide the optimum flow of water onto the surface below (angle of impact: 90°).

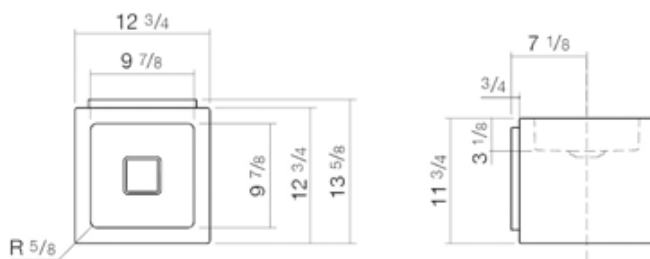

Text for invitation to tender

Washstand, square, 12 3/4 x 12 3/4", basin square and centred, glazed inside and outside, height 11 3/4", without faucet hole and overflow, including fixing set and drain valve with white glazed cap

Brand: Alape

Model: WT.QS325X